

THE CLUBHOUSE

A new venue available for hire, on the outskirts of Brighton. Ideal for team meetings, staff away-days, conferences, regular clubs and events. A perfect get-away space for a fresh perspective.

This former golf club building is situated in the heart of a nature reserve and wildling project – Wilding Waterhall. Only a few minutes away from Brighton and surrounding villages, the venue boasts incredible views of rolling hills and rare chalk grassland.

This venue guide includes:

- The story so far
- Facilities at the Clubhouse
- Discover the Wilding Waterhall project and walks
- Our other venues

“Absolute top spot and perfect for our event – such amazing views and an amazing site to explore and discover the wonders of chalk grassland.”

- Previous hirer



Email: info@bhfood.org.uk

Tel: 01273 234 810





THE CLUBHOUSE: THE STORY SO FAR...

For almost 100 years, this site was a golf course. In 2020, a decision was made to transform the site, restoring its ecological significance and natural beauty. Now, the land is managed by Brighton & Hove City Council and the building cared for by the Food Partnership.

WILDING THE DOWNS

The "Wilding Waterhall" project was launched in spring 2022. This ambitious initiative aims to regenerate and protect the precious chalk grassland habitat surrounding The Clubhouse for miles around.

Biodiversity is our planet's life support system. Restoring nature at Waterhall helps to capture carbon, cool the city, clean our air, reduce flood risk, and provide homes for our declining wildlife populations.

A VENUE FOR ALL

The Clubhouse is an inviting community hub available for hire. Whether you're planning a birthday party, corporate event, yoga retreat, or something else, this stunning venue is the perfect, unique setting.

The venue will be all yours and a Food Partnership staff host will be there to welcome you. If you want extra support, we can guide you through the activity packages available, and connect you with local suppliers, caterers, rangers and activity leaders who have previously supported events on site. [More info.](#)

By choosing The Clubhouse, you're not only contributing to the preservation of this historic venue, you're also supporting the Food Partnership's non-profit community work across Sussex.





FINDING THE CLUBHOUSE

The venue is located on the South Downs just south of Devil's Dyke, only a short drive from Brighton or downland villages. It is easily accessible via the A27, A23 and A281, with ample parking. During the summer months the 77 bus route is often the simplest way from central Brighton.

For more info, view our [full travel guide](#).

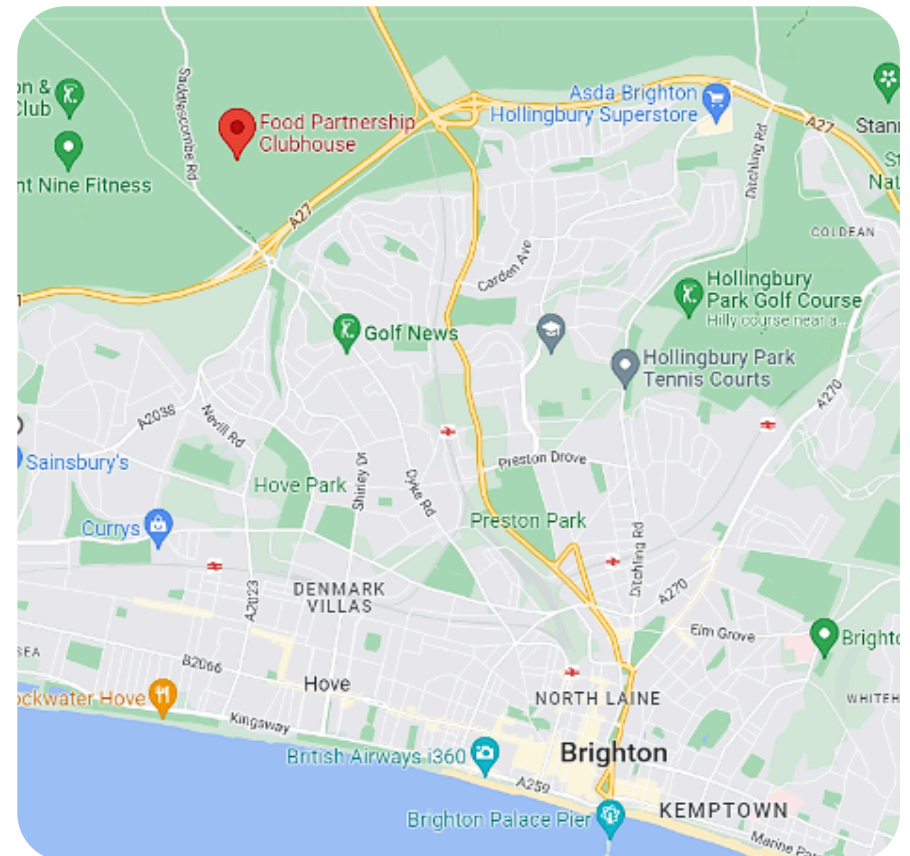

Source - Map data ©2025 Google

FACILITIES AT THE VENUE

The spacious rooms can accommodate up to 75-100 people and include disabled access and a dedicated toilet. The venue is well-lit, and boasts large windows for ample natural light and views. The space is equipped with tables, chairs, kitchen, projector, screen, and WiFi hotspot. Parking is available, plus cycle and walking routes that take in the peaceful surroundings.

100 MAX CAPACITY/ STANDING

56 CABARET STYLE

48 CONFERENCE STYLE

24 BOARDROOM STYLE



B&H FOOD PARTNERSHIP
THE CLUB HOUSE

Email: info@bhfood.org.uk

Tel: 01273 234 810

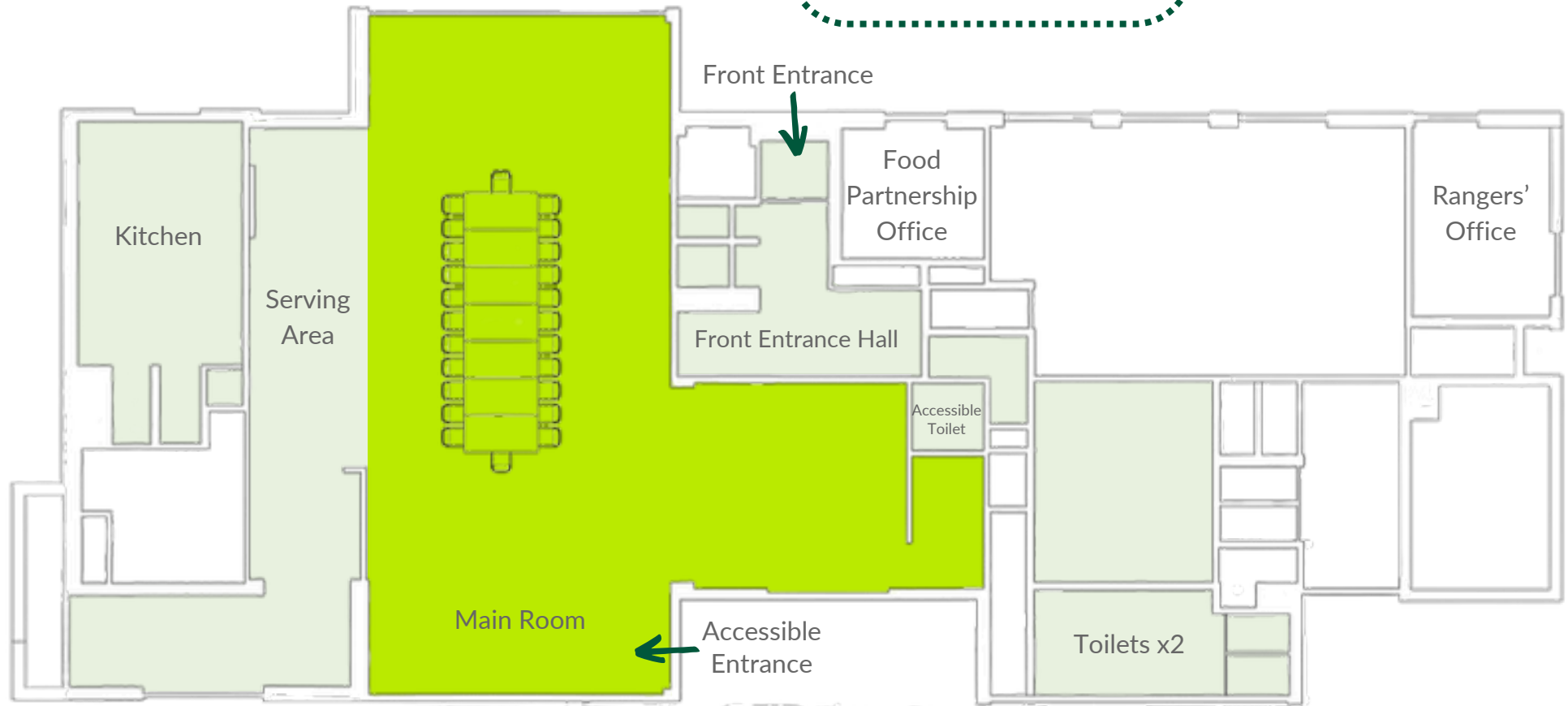

DISCOVER THE WILDING PROJECT

Wilding Waterhall works to restore chalk grassland, improve biodiversity and support public engagement with this environment. Chalk grassland, a vital habitat, has significantly declined over the past 80 years. Human influences have led to the loss of over 80% of this special ecosystem UK wide. To encourage the delicate balance to recover, Waterhall is carefully managed by a dedicated team of rangers and volunteers.

From soaring skylarks to tiny insects, this land now teems with life. Make the Clubhouse your base as you explore the diverse habitats, from vibrant chalk grassland to serene woodlands. Take time out from the busy pace of life to appreciate and explore the details of the natural world. There are self-guided and guided walks with rubbing discs to learn about local plants and animals.

GUIDED WALKS

We can arrange group wellbeing activities and guided walks where you can learn about the unique South Downs environment. Get in touch to find out more.

MEET THE TEAM CARING FOR THIS LAND

The friendly rangers are hard at work throughout the year to keep Waterhall wild, restoring nature and providing benefits to our city and people. You can look at the [“Friends of Waterhall” Facebook page](#) and [The Changing Chalk website](#) to find out about regular volunteering groups and events.





CIRCULAR WALKS AT WILDING WATERHALL

Skylark stroll - 20-30 mins, Easy & flat, 1.5 km.

Follow the white arrows on blue discs on waymarker posts.

This short path offers great views across the nature reserve and surrounding landscape and from spring through summer you are certain to hear skylarks singing overhead. Start outside The Clubhouse, at the first waymarker post opposite the Rangers Office. Each of the waymarker posts also carries a metal disc showing a plant or animal that makes its home at Waterhall. These discs can be copied by placing a piece of paper over the disc and using a crayon to make a rubbing.

Rock-Rose Ramble - 30-45 mins, Moderate, 1.8 km with some significant slopes. White arrows on yellow discs.

Explore the southern part of the reserve, passing close to the most biodiverse areas of chalk grassland containing many wildflowers which bloom from May to September. Start outside The Clubhouse, at the first waymarker post opposite the Rangers Office.

Buzzard Hike - 60-75 mins, More challenging, 3.9 km.

Steep slopes with occasional mud and uneven ground.

White arrows on brown discs.

Pass through all the major habitats on the reserve, from chalk grassland and scrub to mature hawthorn woodland. Loop around the dew pond. You are very likely to see buzzards soaring overhead, so listen for their distinctive “mewing” calls. To start, walk back up the drive to the bend, or start from the main gate, from one of the car parks or from the Dyke Approach bus stop.

Guided walk packages are available. Contact us for info.



OUR VENUES

Email: info@bhfood.org.uk

Tel: 01273 234 810

When you hire a space with us, your booking directly supports our community programmes. Our non-profit organisation is dedicated to empowering people to cook together, access nutritious food, grow their own, and reduce food waste.



THE CLUBHOUSE

Our new venue just a stones throw from Brighton, nestled in the heart of the Wilding Waterhall project in the South Downs. Offering stunning views and a tranquil setting, ideal for team away days, conferences, parties and club gatherings.

[More info](#)



THE COMMUNITY KITCHEN

Our central Brighton venue, ready to host your exciting culinary experience. The large dining table and well-equipped kitchen area makes it easy to host supper clubs, dinner parties, community bake offs, team building or entertaining clients.

[More info](#)



STANMER WELLBEING GARDENS

Three woodland spaces available to hire for regular events at Stanmer Wellbeing Gardens, in the heart of Stanmer Park. Perfect for those looking for a stress-free way to connect with nature in beautiful surroundings with convenient facilities.

[More info](#)